

Lincoln Park/Cotter Community Advisory Group

January 27, 2011 Meeting Minutes

Attendees:

Citizens: Sharyn Cunningham, Carol Dunn, Mark and Kay Denniston, Anita Minton
Canon City Council: Pat Freda
Fremont County Commissioners: Mike Stiehl
Colorado Dept Public Health and Environment: Jeannine Natterman, Steve Tarlton
Environmental Protection Agency: Fran Costanzi

Mike Stiehl chaired the meeting.

Public Comment

None.

Updates – Please see PowerPoint slides attached to these minutes.

Steve Tarlton provided the project updates. Regarding the RAP surety, Cotter proposed \$3 million and the state proposed \$10 million. Various items are in dispute, but it's not clear which ones. The parties are taking the issues into dispute resolution.

Cotter has completed ore pad and CCD tank removal, but hasn't completed CCD tank removal. Cotter will be providing CDPHE project completion reports and decommissioning reports on an ongoing basis (not annually).

Q: Does the state require Cotter to provide receipts for work done?

A: No. The state uses the value in the surety calculation. They might spend more or less, but the state goes with its estimate of what it would cost if the state had to do the work.

Q: Can the timing of the report be before the CAG meetings so the group can be updated.

A: Will try to get Cotter to do that.

Q: Why are the cleanup levels not determined before they do the work?

A: They're not sure what they're dealing with going in.

By July 2011 Cotter anticipates they will have completed another \$2 million in work. They also say when they complete this project, they want to have the whole site finished within a year.

Q: Is sulfation the same as SX?

A: No. Couldn't remember what SX stands for.

Dam to Ditch:

There appears to be a stagnant, non-moving hydrogeologic area. There's also a big dry (no ground water) area between the golf course plume and the main Lincoln Park plume (between west SCS dam and east SCS dam).

Andrew Schmidt with EPA has been working with the hydrogeologists from CDPHE and Cotter to study the area.

Mike Stiehl commented that the ditch company is resistant to using the ditch as a conveyance for any flushing. She also commented that since Cotter has stopped all water going into Lincoln Park; thus there is no recharge to the wells. She thinks there's a good reason for lining the ditch to prevent leaking into Lincoln Park and the wells.

Question: Would the contamination have deposited there or is it naturally occurring?

Answer: It's probably naturally occurring – due to flooding.

Ore Pads:

There's been an elevated gamma level along the Cotter/Golf Course property line. The ore pads need to be removed to determine if there's any impact to the golf course. We're still trying to find a link between the mill area and the golf course plume.

The Secondary Impoundment interim cap is in place. Ultimately there will be a cap 'system' in place – a multi layer system with a final vegetation layer.

Primary and Secondary Impoundments will be sealed to prevent water from leaching. Then they will be turned over to DOE at closure. If a heap leach operation were to be licensed, then the Impoundments are not in closure.

Q: Has there been anything they have demolished that had to be shipped off – couldn't put in the primary impoundment? What happened to slag from Argentina that was high in Thorium? How many buildings are left standing? How many people are working out there?

From Cotter:

Note that the semiannual report provides that info. I copied the latest below. Since that time we have disposed the Amazon (last couple of days) and Euxenite ores (October 2010) [in the primary impoundment]. In addition we have disposed the Calcium Molybdate and Vanadium Concentrates (October 2010). We have 31 employees and up to 10 demo contractors.

Ore and Materials Inventory as of June 30, 2010

- *Uranium-Zirconium (U-Zr) Ore – Approximately fifteen thousand (15,000) tons are stored on the new ore pad west of the old catalyst processing building (demonstration plant). In addition, approximately seven hundred (700) tons of U-Zr ore are in ore bins 3 & 4.*
- *Western Slope Ore (uranium-vanadium) – Approximately six thousand eighty (6,080) tons of SM-18, JD-6, JD-8, and JD-9 ore were stored on ore stockpile #2.*
- *Amazon Ore – Approximately thirty (30) tons in bulk bags were stored in two (2) sea-pack containers south of the old catalyst processing building (demonstration plant). (This material is for potential pilot process testing.)*
- *Euxenite Ore – Approximately twenty (20) tons in 55-gallon drums are stored in the Old Moly SX Building (Barrel Storage).*

Finished Product Inventory as of June 30, 2010

- *Calcium Molybdate Concentrate – Approximately forty-five (45) tons in 55-gallon drums were stored in the Moly SX Building (Barrel Storage).*
- *Vanadium Concentrate – Approximately ninety-nine thousand nine hundred seventy (99,970) pounds of V₂O₅ were stored in 55-gallon drums inside the Product Building.*
- *Yellowcake Concentrate – No uranium concentrate was stored in the Product Storage Building.*

Question: January 24 letter says state has gotten 6 work plans, but it looks like only 4 are posted. What are the other 2?

Q: What are the studies being conducted onsite or offsite?

A: Don't have the master schedule.

Comment: Cotter is paying for the analyses. Can't the state require that thy state get the results instead of Cotter getting them?

Soil Study

Northwest of golf course the soil is being assessed for elevated level of radioactivity. Report will be done in April; basically, they're looking for a fingerprint.

ATSDR Public Health Assessment

They are apparently working on the comments. They probably won't have the report out until late summer or fall. They go 60 pages of comment. They also have an additional layer of peer review.

RAP/ROD Path Forward

Coordination continues – Edgar Ethington is on site coordinator; Wendy Naugle is Superfund specialist. All are basically coordinating schedules right now.

Next Meeting Agenda:

RAP to ROD

Mediation on RAP Surety

Cotter Cañon City Status

Steve Tarlton

CDPHE

January 27, 2011

Financial Assurance Status

- Decommissioning Funding Plan released for public comment on 10/26/10
- Two sets of comments from CCAT received by 11/24/10
- Plan finalized on 12/15/10
- CCAT's revised complaint filed in Denver District Court on 1/14/11

Financial Assurance Status (cont'd)

- The Plan included lists of projects to be completed by 12/10 and by 7/11.
- Cotter submitted a schedule for 2011 projects on 12/10/10; supplemented on 12/13/10.
- Some 12/10 projects not completed; additional \$1,080,000 in surety under discussion.
- RAP financial assurance going into mediation under Consent Decree.
- Cotter has agreed to pay undisputed RAP financial assurance amounts.

Financial Assurance Status (cont'd)

- The January amount was tied to the completion by January of the following:

• Four ore pads	\$900,000
• CCD Tanks	\$500,000
• CCD soils	\$180,000
• Secondary impoundment interim cover	<u>\$450,000</u>
• Total	\$2,030,000

Financial Assurance Status (cont'd)

- These projects must be completed by July 2011 and include:
- Secondary Crusher \$68,673
- Grind/Leach Bldg \$607,301
- Catalyst Bldg \$273,411
- SX Bldg \$547,783
- Miscellaneous Bldgs \$415,432
- Zirconium Bldg \$133,769
- Silica Bldg \$71,390
- Total projects \$2,117,759

Dam to Ditch Project

- Determine why the area groundwater is not cleaning up as expected.
- Define where the groundwater exists and where it is moving.
- Check for golf course plume impacts below the west SCS Dam.

Dam to Ditch Study Area

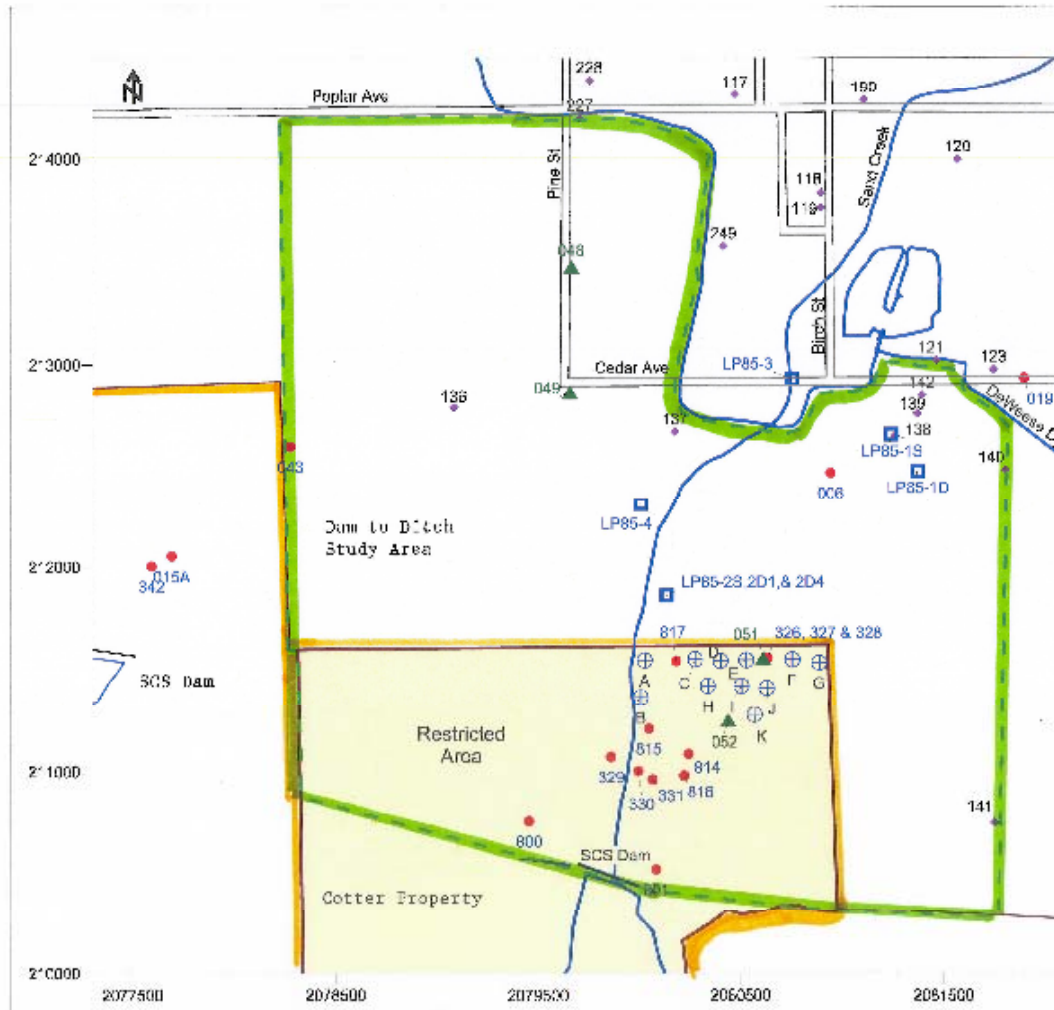

Dam to Ditch preliminary results

- A hydrogeologic barrier exists between the areas below the West SCS Dam and the SCS Dam.
- Groundwater moving north from the West SCS Dam is below standards.
- The number of dry wells shows that groundwater is not continuous in the area below the SCS Dam.

Dam to Ditch questions

- Why are levels in Well 006 persistent?
- Is contamination bound up in the soil and rock and leaching out slowly when the water table changes?
- Will flushing the area eliminate residual contamination?

Progress on Cleanup Activities at Cotter

CAG Meeting
January 27, 2011

Original Short Term Scope

- Ore Pads
- CCD Tanks
- CCD Soils
- Secondary Impoundment random fill

Original Short Term Scope

- Ore Pads – partially complete
- CCD Tanks - complete
- CCD Soils – deferred to summer
- Secondary Impoundment random fill - complete

Added to Scope - complete

- Secondary bag house
- Secondary crusher conveyor
- Grind/leach conveyor
- Primary crusher-day ore bin
- Old mill electric shop
- Old mill office/shop
- Schwartz ore crusher area

To be complete by July 2007

- Secondary crusher
- Grind/leach building
- Catalyst building
- SX building
- Misc buildings
- Zirconium building
- Silica building

Ore Pads



Ore pads – in progress



1958 Pad (taken July 29, 2010)

Front gate ore pad (taken 10/19/09)



CCD Tanks - Before



CCD Tanks Demo



CCD Tanks - After



Secondary Impoundment – Random Fill



Secondary Baghouse



Secondary Crusher Conveyor



Primary Crusher Day Bin



Old mill shops

